

REV	ECN	DESCRIPTION	DATE	DR	CK

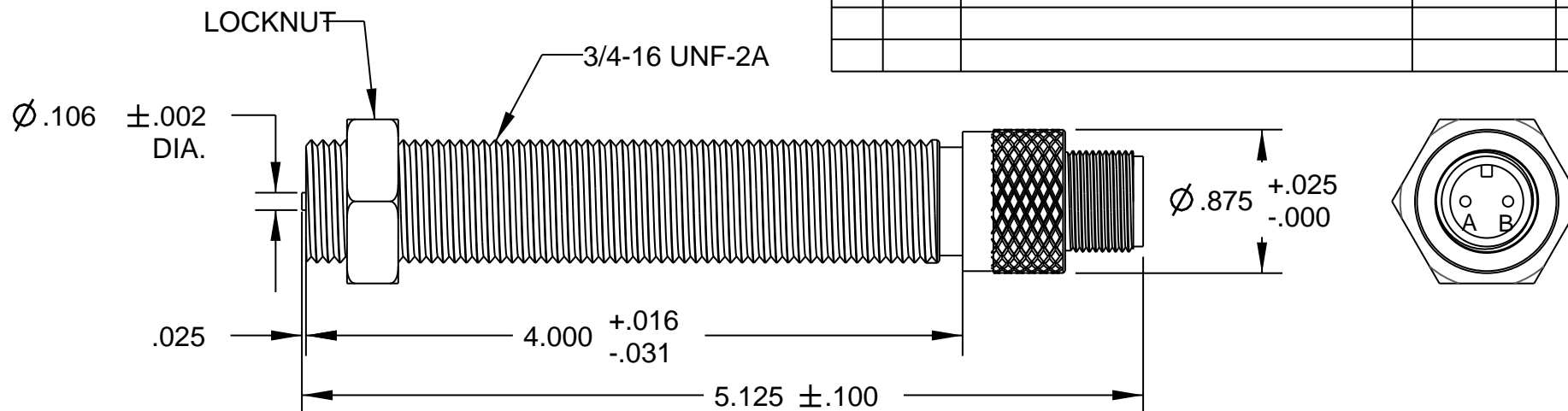

TEMPERATURE RANGE	OUTPUT VOLTAGE (SEE NOTE 1)	DC RESISTANCE AT 75 °F	INDUCTANCE AT 1Khz	OUTPUT LEADS (SEE NOTE 2)	INSUL. RESISTANCE AT 500 VDC	NET WEIGHT
-65 °F to +225 °F	160-240 V P-P	1000-1300 OHMS	360 MH NOM.	MATES WITH MS3106A-10SL-4S	100 MEGOHMS MIN. COIL TO HOUSING	

#### NOTES:

1-TESTED AT 1000 INCHES/SECOND WITH A 20 PITCH, 30 TOOTH GEAR, 0.005" CLEARANCE AND 100,000 OHM LOAD SHUNTED BY 250 PF.

2-WITH APPROACH OF FERROUS METAL, PIN "B" IS POSITIVE WITH RESPECT TO PIN "A".

#### CONSTRUCTION:

HOUSING ----- 303 STAINLESS STEEL  
POLE PIECE --- 416 STAINLESS STEEL  
POTTING ----- EPOXY RESIN

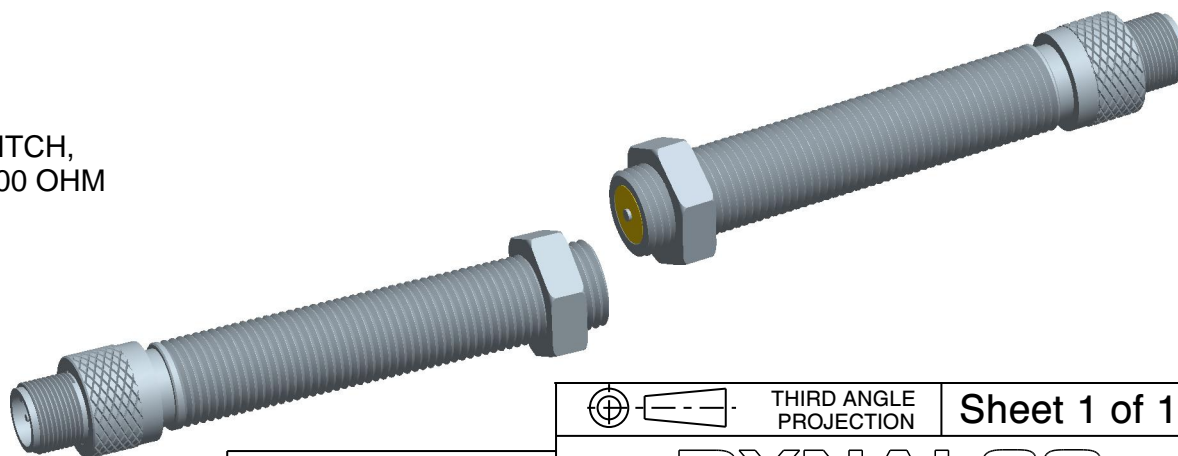

TOLERANCES	DEC.	ANGLES
FRACT.	XXX ±.005	±1/2°
	.XX ±.01	

MATERIAL

FINISH

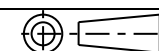

THIRD ANGLE  
PROJECTION

Sheet 1 of 1

**DYNALCO**

MODEL	M306	DRAWN	PF	SCALE
PATH	NPROD\PICKUPS\M306	APPROVED	BR	NONE
TITLE	MAGNETIC PICKUP, MODEL M306			

DATE	11/11/10	A	8000306	REV
				-

THIS DOCUMENT, ALL INFORMATION CONTAINED IN AND ALL INFORMATION RELATED TO, IS PROPERTY OF DYNALCO. CONTROLS, IS CONFIDENTIAL TO IT AND NO PART THEREOF NOR ANY SUCH INFORMATION MAY BE COPIED, DISSEMINATED OR USED IN ANY MANNER WHATSOEVER WITHOUT THE PRIOR WRITTEN CONSENT OF DYNALCO AND IS TO BE RETURNED TO DYNALCO UPON REQUEST.